

CASE STUDY



ASSET	FIXED PLATFORM	TEAM	7 PERSON (MULTI DISCIPLINED)
LOCATION	NORTH SEA	DURATION	2 YEARS

PROJECT OVERVIEW

Full EPC Contract for the preparation of concrete legs for topside removal on an offshore production platform that is scheduled to be removed by heavy lift vessel in 2021. Project delivered in the form of integrated engineering, procurement and construction services under turnkey contract.

SCOPE OF WORK

- Multi-discipline FEED study for the internal clearance of all legs within the proposed cut line
- EPC contract for all external and internal leg clearance activities
- Internal clearance of all structural items, piping, electrical, HVAC and lift systems
- External leg clearance of escape to sea ladders, spider deck walkways and pipework systems
- Multi-discipline FEED study for the design of a capping system post topside removal
- EPC contract covering the complete capping system
- Leg Capping includes structural modifications, grouting and coatings

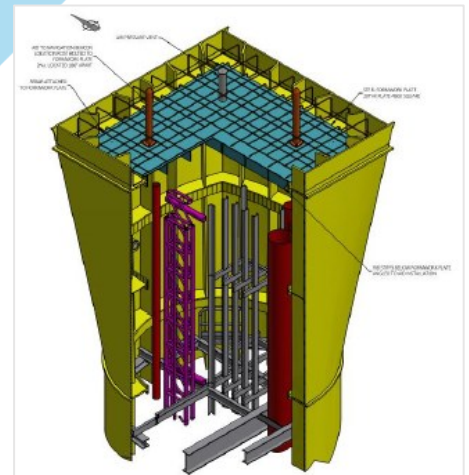
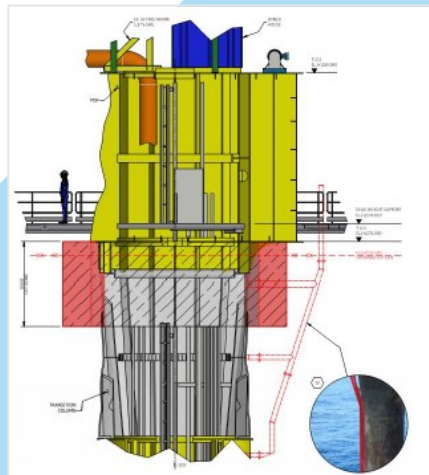
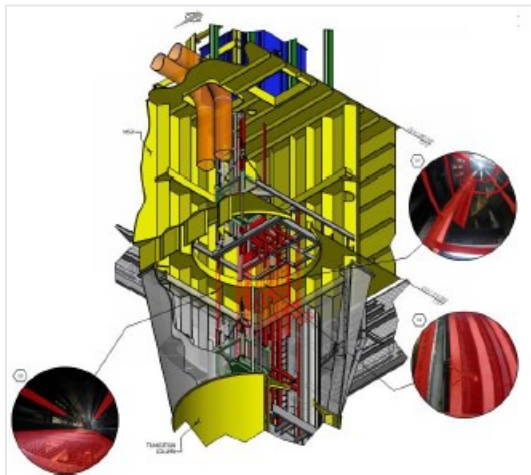

CLIENT CHALLENGES

- All internal worksites classified as confined space hazardous area
- Platform still fully manned with significant PoB restrictions
- All worksites very congested making lifting operations complex
- Legs contain live cabling and pipework some of which are to be maintained up to final abandonment
- No existing precedent for the capping of the legs



AQUATERRA SOLUTIONS

- Onshore project management team, with dedicated client focal point to provide ongoing project support, scope and vendor management
- Internal capping feasibility studies, design, procurement and installation planned and delivered as turnkey scope
- Engineering and design scopes managed under a construction-led engineering approach, delivered by multi-skilled offshore teams (electrical, mechanical, welding, pipefitting, coating, access, etc.)
- QuikDeck® access system installed within all four legs to assist with both deconstruct and installation
- All lifting and rigging equipment supplied, inspected and maintained by AquaTerra

ADDED VALUE

- ✓ Construction led engineering implemented for leg clearance worksopes meaning lower engineering costs and fit for purpose deconstruct packages
- ✓ AquaTerra's industry leading experience working in concrete legs and hazardous confined space resulted in high productivity and zero LTIs
- ✓ Full turnkey service resulted in limited amount of interfaces and administrative burden for the client

